

Distortion extrapolation procedure

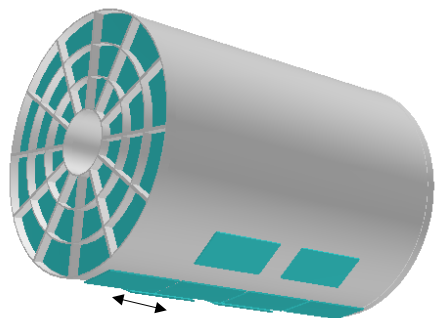

- 1) small z interpolation between Micromegas modules

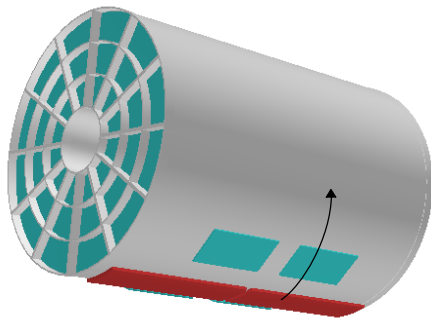

- 2) copy z dependence to other sectors of the TPC using Central Membrane data for normalization

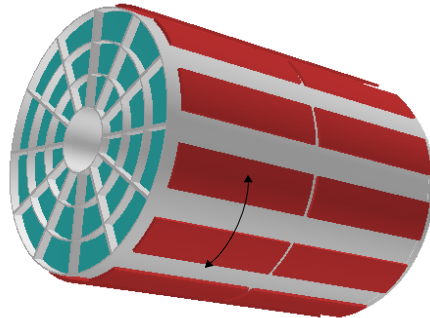

- 3) Linear interpolation between sectors to cover full acceptance, possibly driven by Central Membrane data

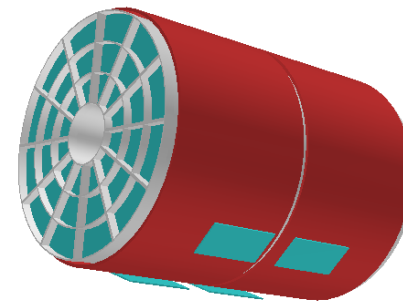

- 4) Compare extrapolated distortions to measurements from Micromegas, to validate the extrapolation and assign systematic uncertainties